



## BIDIRECTIONAL ESD PROTECTION DIODES

### Features

- Operating voltage : 15V
- 350 Watts Peak Pulse Power per Line ( $t_p = 8/20\mu s$ )
- Protects One Power or I/O Port
- Low Clamping Voltage
- Ultra Low Capacitance: 0.8 pF Typical
- Bidirectional Configuration

### Applications

- Ethernet - 10/100/1000 Base T
- Cellular Phones
- Handheld - Wireless Systems
- Personal Digital Assistant(PDA)
- USB Interface

### Mechanical Characteristics

- SOD-323W package
- Packaging: Tape and Reel per EIA 481
- Marking : 15U
- RoHS Compliant

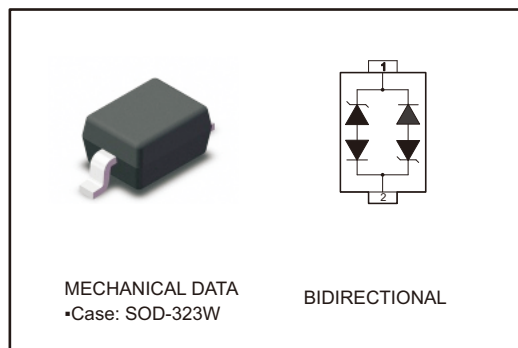

### Electrical Parameters (T=25 °C )

Symbol	Parameter
$I_{PP}$	Reverse Peak Pulse Current
$V_C$	Clamping Voltage @ $I_{PP}$
$V_{RWM}$	Reverse Stand- Off Voltage
$I_R$	Reverse Leakage Current @ $V_{RWM}$
$V_{BR}$	Breakdown Voltage @ $I_T$
$I_T$	Test Current

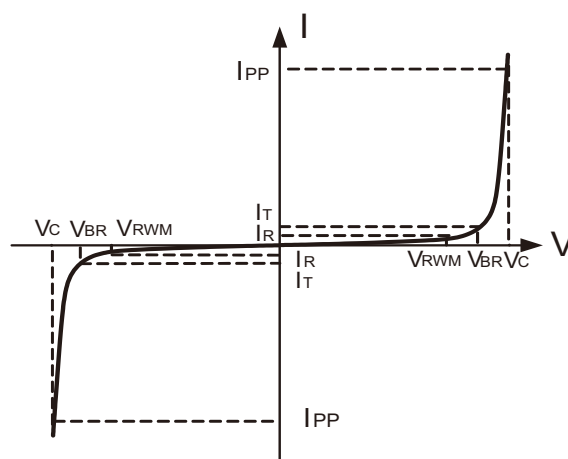



**MAXIMUM RATINGS (Ta =25°C unless otherwise noted)**

Parameter	Symbol	Value	Unit
Peak Pulse Power (8/20 $\mu$ S)	Ppk	350	W
Peak Pulse Current	Ipp	10	A
ESD per IEC 61000-4-2 (Air)	VESD	$\pm 30$	KV
ESD per IEC 61000-4-2 (Contact)		$\pm 30$	
Operating Junction Temperature	TJ	-55~ +150	°C
Storage Temperature Range	Tstg	-55~ +150	°C

**ELECTRICAL CHARACTERISTICS ( TA = 25°C unless otherwise noted )**

Parameter	Symbol	Test conditions	Min	Typ	Max	Unit
Reverse stand-off voltage	VRWM				15.0	V
Breakdown Voltage	VBR	IT=1mA	16.7			V
Reverse Leakage Current	IR	V=VRWM , Ta=25°C			1	$\mu$ A
Clamping Voltage	VC	IPP=1A , tp=8/20us			24	V
		IPP=5A , tp=8/20us			29	V
		IPP= 10A , tp=8/20us			31.8	V
Junction Capacitance	Cj	VR=0V , f=1MHz		0.8		pF



Fig.1 Peak Pulse Power vs. Pulse Time

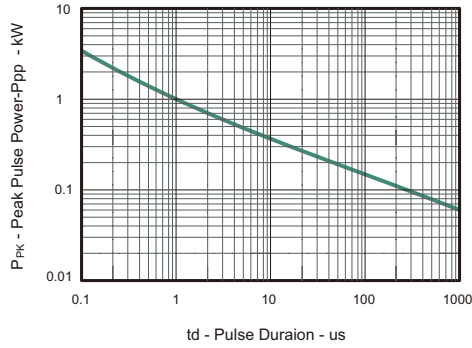

Fig.2 Forward Current Derating Curve

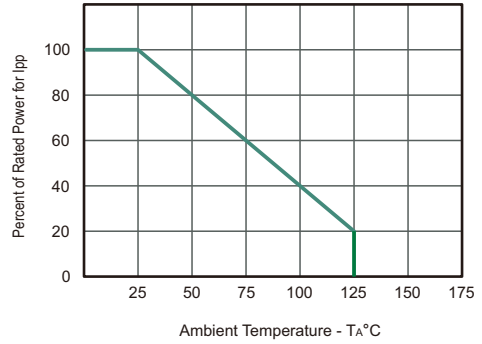

Fig.3 Clamping voltage vs I<sub>pp</sub>

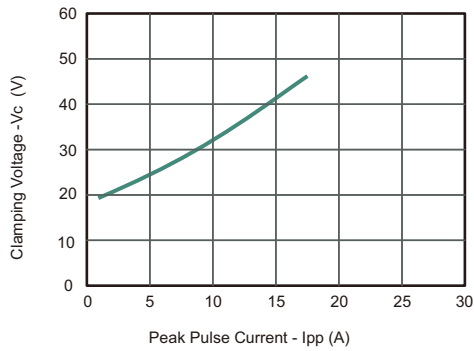
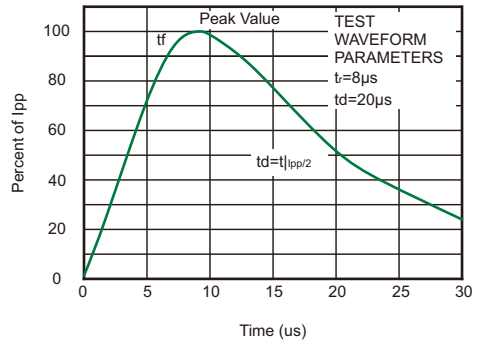

Fig.4 Pulse Waveform





**PACKAGE OUTLINE**

Plastic surface mounted package; 2 leads

SOD-323W

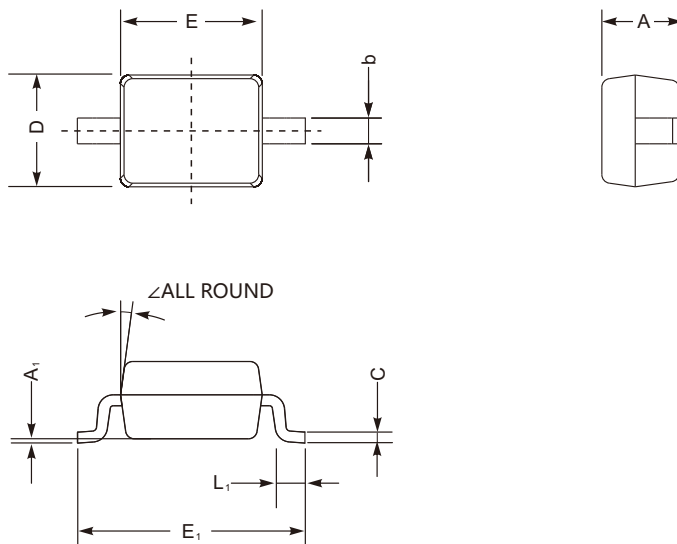

SOD-323W mechanical data

UNIT		A	C	D	E	E <sub>1</sub>	b	L <sub>1</sub>	A <sub>1</sub>	∠
mm	max	1.1	0.15	1.4	1.8	2.75	0.4	0.45	0.2	9°
	min	0.8	0.08	1.2	1.4	2.55	0.25	0.2	—	
mil	max	43	5.9	55	70	108	16	16	8	
	min	32	3.1	47	63	100	9.8	7.9	—	

**The recommended mounting pad size**

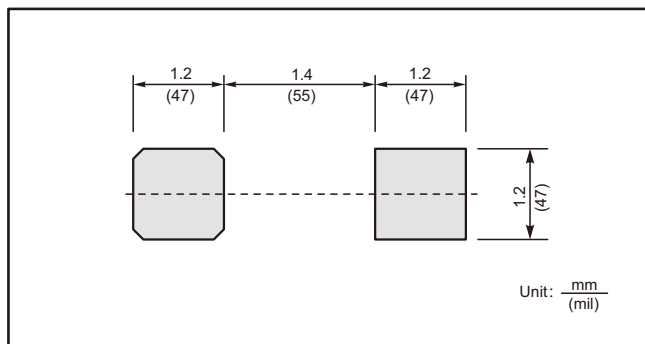

**Marking**

Type number	Marking code
ESDBLC15V0D3	15U



## Important Notice and Disclaimer

Jingdao Microelectronics reserves the right to make changes to this document and its products and specifications at any time without notice.

Customers should obtain and confirm the latest product information and specifications before final design, purchase or use.

Jingdao Microelectronics makes no warranty, representation or guarantee regarding the suitability of its products for any particular purpose, not does Jingdao Microelectronics assume any liability for application assistance or customer product design.

Jingdao Microelectronics does not warrant or accept any liability with products which are purchased or used for any unintended or unauthorized application.

No license is granted by implication or otherwise under any intellectual property rights of Jingdao Microelectronics.

Jingdao Microelectronics products are not authorized for use as critical components in life support devices or systems without express written approval of Jingdao Microelectronics.



文件履历表

版次	修订内容	修订原因	编制日期	编制人
2.1	文控版首次建立	首次受控	2024-11-14	李祥正